

Technical data sheet



Product features

Cooling counter 2x2 drawer

Model	SAP Code	00013324
--------------	-----------------	----------



- Material: Stainless steel
- GN / EN size in device: GN 1/1
- Number of GN / EN: 4
- Number of drawers: 4
- Control type: Digital
- Minimum device temperature [°C]: 2
- Maximum device temperature [°C]: 8
- Max ambient temperature [°C]: 43
- Insulation thickness [mm]: 35
- Unit: Down
- Automatic defrost: Yes

SAP Code	00013324	GN / EN size in device	GN 1/1
Net Width [mm]	900	GN device depth	150
Net Depth [mm]	700	Minimum device temperature [°C]	2
Net Height [mm]	880	Maximum device temperature [°C]	8
Net Weight [kg]	89.00	Refrigerant	R290
Power electric [kW]	0.200	Worktop material	SS201
Loading	230 V / 1N - 50 Hz	Refrigerant weight [g]	80.00
Energy class	C	Climate class	4
Chamber volume [l]	166	Worktop Thickness [mm]	35.00
Number of drawers	4	Height with rim [mm]	915
Number of GN / EN	4	Thickness back rim [mm]	1.50

Technical data sheet



Technical drawing

Cooling counter 2x2 drawer

Model

SAP Code

00013324

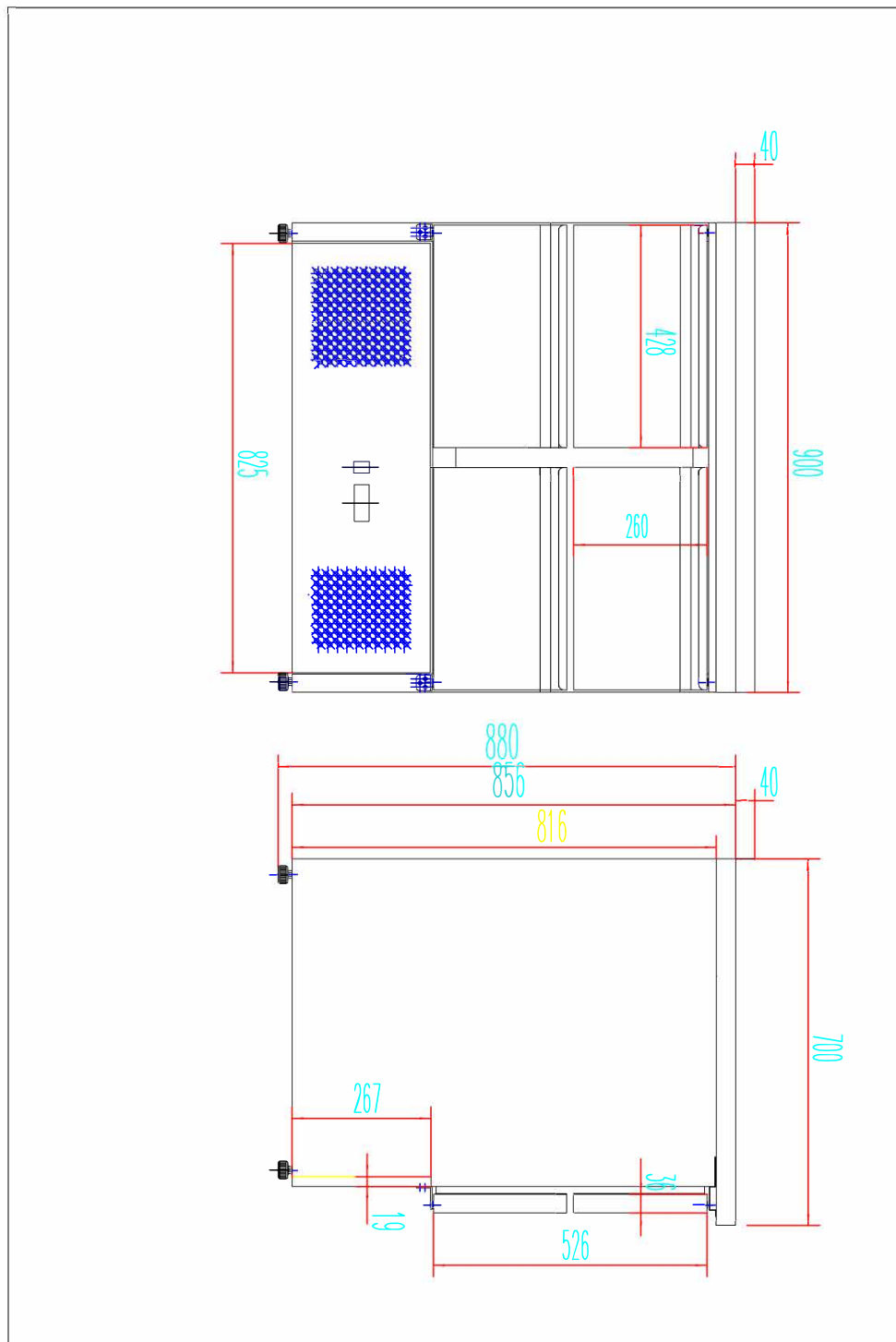

Technical data sheet



Technical parameters

Cooling counter 2x2 drawer

Model

SAP Code

00013324

1. SAP Code:

00013324

2. Net Width [mm]:

900

3. Net Depth [mm]:

700

4. Net Height [mm]:

880

5. Net Weight [kg]:

89.00

6. Gross Width [mm]:

970

7. Gross depth [mm]:

765

8. Gross Height [mm]:

1095

9. Gross Weight [kg]:

99.00

10. Device type:

Electric unit

11. Power electric [kW]:

0.200

12. Loading:

230 V / 1N - 50 Hz

13. Energy class:

C

14. Refrigerant:

R290

15. Cooling type:

Static

16. Material:

Stainless steel

17. Exterior color of the device:

Stainless steel

18. Min ambient temperature [°C]:

10

19. Max ambient temperature [°C]:

43

20. Additional information:

Internal dimensions of drawers 304*523*140 mm

21. Device properties 2:

Cooling

22. GN / EN size in device:

GN 1/1

23. Number of internal parts:

4

24. Number of GN / EN:

4

25. GN device depth:

150

26. Chamber volume [l]:

166

27. Worktop material:

SS201

28. Insulation thickness [mm]:

35

Technical data sheet



Technical parameters

Cooling counter 2x2 drawer

Model

SAP Code

00013324

29. Number of drawers:

4

30. Unit:

Down

31. Control type:

Digital

32. Annual energy consumption [kWh]:

883

33. Minimum device temperature [°C]:

2

34. Maximum device temperature [°C]:

8

35. Automatic defrost:

Yes

36. Refrigerant weight [g]:

80.00

37. Gross Volume [m3]:

0.813

38. Net Volume [m3]:

0.554

39. Climate class:

4

40. Worktop Thickness [mm]:

35.00

41. Height with rim [mm]:

915

42. Thickness back rim [mm]:

1.50